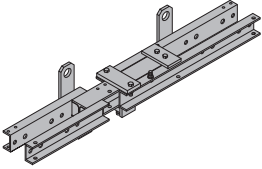

[kg] Article n°

[kg] Article n°

Telescopic shaft beam 1.45-1.65m	65.9	580686000
Telescopic shaft beam 1.65-2.00m	65.0	580687000
Telescopic shaft beam 2.00-2.70m	107.5	580688000
Telescopic shaft beam 2.70-3.80m	156.5	580689000
Telescopic shaft beam 3.80-5.90m	261.0	580690000
Teleskop-Schachträger		

Galvanised

**Tie rod wrench 15.0/20.0**

Ankerstabschlüssel 15,0/20,0

1.9 580594000

Galvanised  
Length: 37 cm  
Diameter: 8 cm

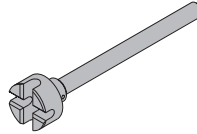
**Pawl for shaft platform**

Klinke für Schachtbühne

18.0 580466000

Galvanised  
Length: 55 cm  
Width-across: 19 mm

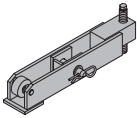
**Box for latch 20x20x15cm**

Aussparungskasten 20x20x15cm

2.6 580608000

Powder-coated, blue

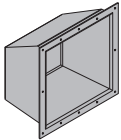
**Plug 15.0**

Verschlussstopfen 15,0

0.006 580609000

Colourless  
Diameter: 1.9 cm

**Main beam head**

Bühnenkopf

14.9 580464000

Painted blue  
Length: 49 cm

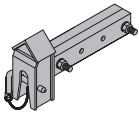
**Tool box GF**

GF-Werkzeugbox

6.5 580390000

included in scope of supply:

(A) Reversible ratchet 1/2"	0.73	580580000
Galvanised		
Length: 30 cm		
(B) Fork wrench 13/17	0.08	580577000
(C) Fork wrench 22/24	0.22	580587000
(D) Fork wrench 30/32	0.80	580897000
(E) Ring spanner 17/19	0.27	580590000
(F) Extension 11cm 1/2"	0.20	580581000
(G) Extension 22cm 1/2"	0.31	580582000
(H) Universal joint coupling	0.16	580583000
(I) Nut for box spanner 19 1/2" L	0.16	580598000
(J) Box nut 13 1/2"	0.06	580576000
(K) Box nut 24 1/2"	0.12	580584000
(L) Box nut 30 1/2"	0.20	580575000

